



# Columbia Shuswap Regional District

555 Harbourfront Dr. NE, Salmon Arm, BC V1E 4P1  
Phone: 250.832.8194 | Fax: 250.832.3375  
Web: www.csr.d.bc.ca | E-Mail: inquiries@csr.d.bc.ca

## Property Report

Parcel Number (PID): 023-790-954  
IDParcel: cebp0371  
Report Date: 9/21/2016

### Property Details

Address: No Address  
PID: 023-790-954  
Roll: 78904036082  
Electoral Area: C  
Local Area: eb  
Ownership: Private  
Zoning: Bylaw 701: RR1 - Rural Residential (.4ha)  
OCP: Bylaw 725: NR - Neighbourhood Residential  
Lakes Zoning: No Lakes Zoning  
Land Use: Residential  
GIS Lot Size: 0.51 HA | 1.25 Acres  
Taxable Value: \$65,700  
Percent in ALR: 0

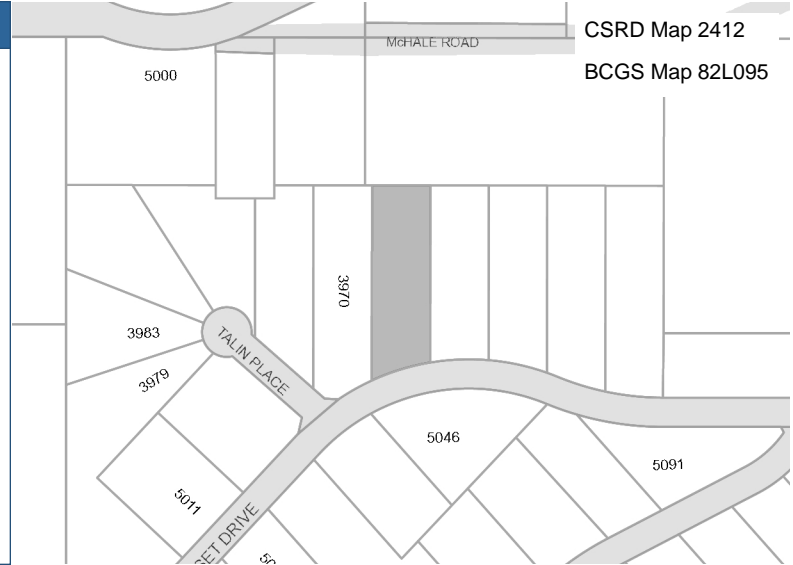

### Legal Description

Legal Plan:	KAP59248	Section:	4	Land District:	Kamloops
District Lot:		Township:	23	Freeform:	L 82 SEC 4 TP 23 R 9 W OF THE SIXTH MERIDIAN KAMLOOPS DIVISION
Block:		Range:	9		YALE DISTRICT PL KAP59248
Lot:	82	Meridian:	6		

### BCAA - Property Details

Roll Number: 78904036082  
Roll Year: 2016  
Assess Area: 20 - Vernon  
Jurisdiction: 789 - Salmon Arm Rural  
Neighbourhood: 500 - Carlin To Squilax (Backland)  
Regional District: 08 - Columbia Shuswap  
Electoral Area: C  
School District: 83  
Hospital District: 03  
Use Category: 001 - Single Family Residence  
Actual Use: 001 - Vacant Residential Less Than 2 Acres  
Manual Class:  
Tenure: 01 - Crown-Granted

### BCAA - Minor Taxing

Defined Area	Elect Area C Sub-Regional Fire Service, Fireworks Area C, Sorrento/Blind Bay Fire Dept, South Shuswap Sewer
Specified-Regional	
Service Area	Okanagan Regional Library, Shuswap Watershed
Improvement District	
Local Community	

### BCAA - Valuation

Taxable	\$65,700
Exempt	\$0
<b>Net Taxable Value</b>	<b>\$65,700</b>

### BCAA - Sales History

Current Sale	\$44,393	2005
First Previous	\$31,000	2002
Second Previous	\$1	2001